

DESIGN FOR A

BETTER WORLD :

TINT

102 & 112

Course Hours: TINT 102 DAYS, TUESDAYS 09.00-17:00 + FRIDAYS 09:00-12:00
TINT 112 DAYS, WEDNESDAYS 13:00-17.00

Instructors:

Asst. Prof. Güliz Öktem Tasdemir, Ins.Dr.Selim Sertel Öztürk,
Ins. Yeşim Kutkan Öztürk

guliz.tasdemir@tedu.edu.tr (For Any Questions or Reasons)

(F403 - Office Hours: Wednesdays 10:00-11:00)

*<https://lms.tedu.edu.tr/course/admin.php?courseid=1874>

Design and Research Agenda of Studio 102 & 112

The sense of sustainability idea has emerged since 1980's. From that moment, the physical environment and the social construction aspect were separated into two according to a distinct general heading. Based on this idea, the United Nations has defined seventeen sub-headings on a universal scale. In the context of the sustainability goals below, studio instructors expect civil workspaces to be designed for matched various corporate identities. Scenario design, user group, the location of the civic office will be randomly pick by the students.thus, research, idea development and spatial atmosphere development steps will be followed.

TED ANKARA COLLAGE FOUNDATION, CENTER for GENDER STUDIES (TEDU), TEMA FOUNDATION, UNICEF, GREENPEACE, AFAD, AHBAP, UNITED NATIONS, MINISTRY OF AGRICULTURE AND FORESTRY, CHANGE.ORG. ETC.

First week lessons will be directly related to the research agendas.

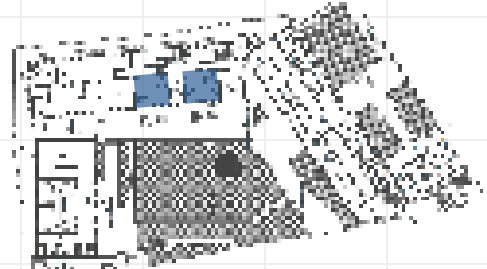
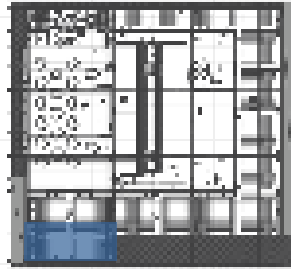

Evaluation Process:

Grading 102 Included: Mid Jury %20 +Mini Jury %10, Final Jury %30+Mini Jury %10, Weekly or Scheduled Moodle Assignments %20, In Class Critics %10

Grading 112 Included: Mid Term Exam %30, Final Exam %40, Weekly or Scheduled Moodle Assignments %20, Your Own Room Ex. %10

In Class Requirements and Attendance

Attendance is mandatory all scheduled classes, field trips and critics. Studio is held on Tuesdays, Wednasdays and Fridays. Tuesdays and Fridays will be at 9:00 am. After 9:10 am you will be responsible for being late and marked as absent. Absences and acute diseases, a personal crisis (death of a family member) will be evaluated only within the scope of official excuses (hospital report etc.).



WEEK	TIN102	TINT112	TINT102
	07.03.2023	08.03.2023	10.03.2023
Week 1	Introduction	"Your Own Room" Introduction	Student Presentations: Scenario Developments
	Discussions on Project Themes, Pair Work, In Class Discussion	Discussions about semester HW.	Guest Speakers: URBAN WALKS
	14.03.2023	15.03.2023	17.03.2023
Week 2	Discussion on Functions and Concepts		Discussion on Functions and Concepts
	Diagrammatic Respresentations of Initial Ideas	Guest Lecturer Zeynep Özkan	Diagrammatic Representatios of Initial Ideas
	21.03.2023	22.03.2023	24.03.2023
Week 3	Discussion on Functions and Concepts	"Your own room"	Guest Lecturer Duygu Yarımbaş
	2D and 3D Representations of Refined Ideas	Plan, Section 1/50	
	28.03.2023	29.03.2023	31.03.2023
Week 4	Introduction to Photoshop Workshop: Dr. Selim Sertel Öztürk	Plan, Section and Drawing	Pin up Critics
	In Class Work (Conceptual Representations)		Plan, Section and 3D Renders
	04.04.2023	05.04.2023	07.04.2023
Week 5	Individual Critics	"Your own room"	Technical Drawing In Class Ex.
	Plan, Section and 3D Renders	Plan, Section 1/50	
	11.04.2023	12.04.2023	14.04.2023
Week 6	MINI JURY	Plan, Section Rendering Workshop: Guest Lecturer ins. Onur Kutluoğlu	MINI JURY
	18.04.2023	19.04.2023	21.04.2023
Week 7	Individual Critics	Enscape Workshop: Furkan Başaran+İlayda Ödel	FEAST OF RAMADAN
	Plan, Section and 3D Renders		
	25.04.2023	26.04.2023	28.04.2023
Week 8	JURY	MIDTERM EXAM	Technical Drawing In Class Ex.
	02.05.2023	03.05.2023	05.05.2023
Week 9	Individual Critics	"Your own room"	Pin up Critics
	Plan, Section and 3D Renders	Plan, Section 1/50, rendered and isometric +exploded axonometric added	Plan, Section and 3D Renders
	09.05.2023	10.05.2023	12.05.2023
Week 10	Individual Critics	"Your own room"	"Your own room"
	Plan, Section and 3D Renders	Plan, Section 1/50, rendered and isometric +exploded axonometric added	Plan, Section 1/50, rendered and isometric +exploded axonometric added
	16.05.2023	17.05.2023	19.05.2023
Week 11	Individual Critics	"Your own room" Pre Final Critics	19TH MAY COMMEMORATION OF ATATURK YOUTH and SPORTS DAY
	Plan, Section and 3D Renders, Poster Critics	Plan, Section 1/50, rendered and isometric +exploded axonometric added	
	23.05.2023	24.05.2023	26.05.2023
Week 12	Individual Critics	Studio Project Technical Drawing	Pin up Critics
	Plan, Section and 3D Renders, Poster Critics	Plan, Section 1/50, rendered and isometric +exploded axonometric added	Plan, Section and 3D Renders
	30.05.2023	31.05.2023	02.06.2023
Week 13	Individual Critics	Studio Project Technical Drawing	Pin up Critics
	Plan, Section and 3D Renders, Poster Critics	Plan, Section 1/50, rendered and isometric +exploded axonometric added	Plan, Section and 3D Renders
	06.06.2023	07.06.2023	09.06.2023
Week 14	Individual Critics	Studio Project Technical Drawing	FUN DESIGN TASK: END OF SEMESTER CELEBRATION
	Plan, Section and 3D Renders, Poster Critics	Plan, Section 1/50, rendered and isometric +exploded axonometric added	





TEDU INTERIOR



Must Have Materials

- T-Square Ruler (75 cm length recommended)
- 45 and 60 degree angled square ruler set
- A3 Drawing Paper (200 gr per sheet, schoeller, canson etc.)
- A3 File with sheet protector, A3 File with transparent 40 files
- Drafting Pencils (Assorted Weight B HB 2B 3B 4B 2H 4H 6H)
- Erasers
- Cutting Knife and Cutting Board
- Glue Stick, Liquid Glue (Please do not use any of **SUPER BOND GLUE TYPE ie.Pattex and Aerosoles Subs.**)
- Wider Hand Brush to clean Eraser and other type of dust
- Compasses
- Sketch Book (Unlined Version A4, If you like you can use semi translucent paper and customize your sketch book)
- Transparent Paper Roll (Aydinger), 33 cm x 20m
- Ink Pen and Marker Types
- Tack It
- Camera or Phone Camera (Hig Resolution Needed)
- Laptop
- *Please download and setup AUTOCAD -Educational Version by downloading Free, Adobe Photoshop +Illustrator, Sketch Up.**

Going Through the Data and Analysing Process

Discussions and debates were fundamental about any kind of development. Through that, our main dialogue and discussions were operated according to data we have or we imagine. That is to say, it is important to gather the knowledge about TINT 102, TINT 112.

Sketching and Drawing is Still So Crucial!

Since the beginning of your educational process. it has been spoken that sketching is an actual idea transmitter. Especially from brain to hand. Drawing at the same time is a process that progresses from seeing to visualizing and finally expressing. Visual information by the eye is processed, manipulated and filtered by the mind.

A Thought/ An Idea/ Please Take Your Notes On!

.....

.....

.....

.....

.....